



**la marzocco**  
handmade in florence

# la marzocco USA technical bulletin 195

**Linea Classic S new “tall cups” version.**

**June 14, 2024**

Dear Friends,

We have recently modified 2,3, and 4 group Linea Classic S to accommodate taller cups.

The change consists in lowering the drain tray by 11mm.

This has also required modifying all components that are indicated in the picture below.

To also facilitate the removal and assembly of the front base, the screw and nut that secure its back side to the machine's frame have been replaced by studs (welded on the panel) and wingnuts.

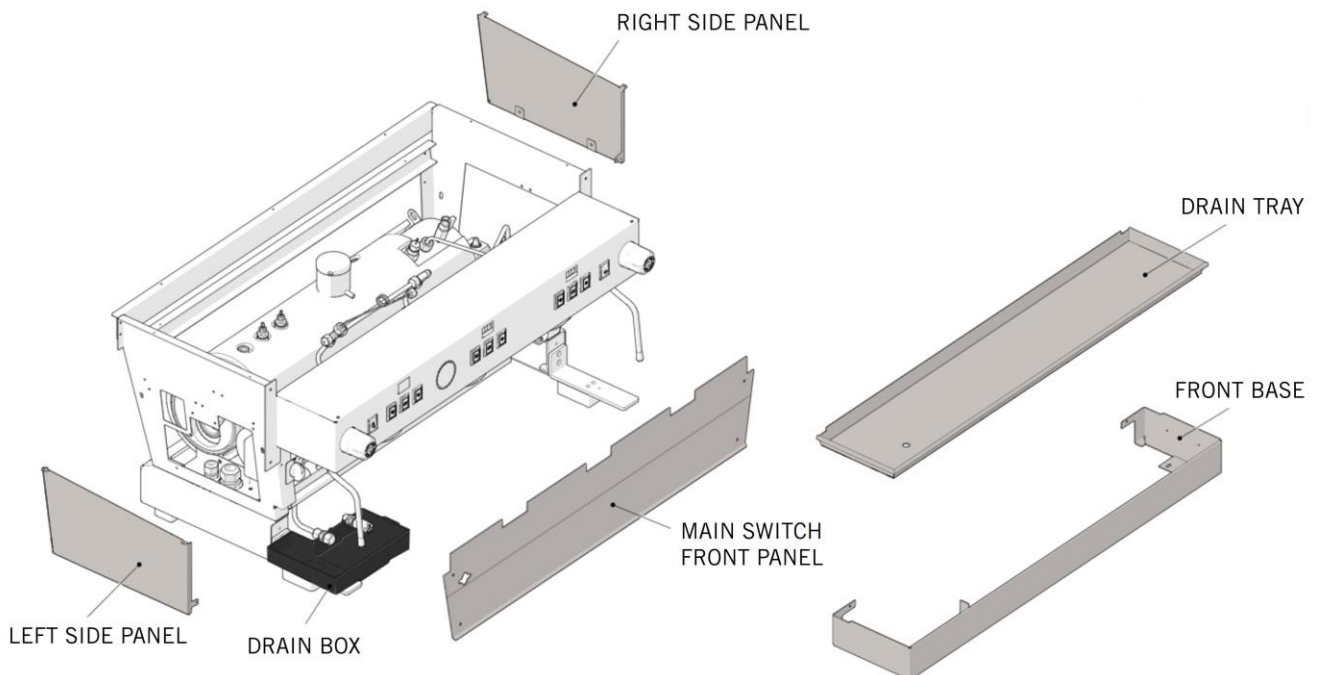



All Linea Classic S starting from the following serial numbers are updated with "high cups" components:

2gr: LS013923

3gr: LS013921

4gr: LS014953

(1gr Linea Classic S has not changed)

Retrofitting older machines to the new version, or vice-versa, isn't suggested, and it's only possible by replacing all "high cups" components (see picture above).

Grids are however interchangeable.

Please note that the stamped drain grid is now standard for new Linea Classic S.

All parts can be found in the Linea Classic S parts manual at [www.lamarzoccousa.com/support](http://www.lamarzoccousa.com/support), pages 10 and 11.

Do not hesitate to contact our solutions team with any questions you may have about this technical bulletin.  
solutions.usa@lamarzocco.com  
206.706.9104 x 101