

la marzocco USA technical bulletin 199

new La Marzocco app

March 18, 2025

Dear Friends,

On March 18th, a unified La Marzocco mobile app will replace the Home and Pro apps, offering a redesigned interface, simplified pairing, and improved connectivity. Existing users will receive an in-app download prompt and retain paired machines. Mandatory firmware updates are required for full compatibility. The following is a brief description of the new app and features.

Key Updates

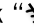
- **Firmware:**
 - Updates (10-40 min) required; machines offline during process.
 - Track updates via app (gateway) and machine display.
 - Do not power off during update.
- **Connectivity:** Displayed in the ALL DEVICES list
 - Green “ CONNECTED”: Full online functionality.
 - Black “ NOT CONNECTED”: Offline, no settings control.
 - Linea Mini / Micra Offline: Bluetooth-only (limited), set during pairing; requires re-pairing for Wi-Fi.
- **App UI:** Four main navigation buttons
 - Dashboard: Current machine operational parameters and programmable settings
 - Scheduling: Eco mode and scheduling on/off times
 - My Stats: Manage widgets and display usage trends.
 - Settings: Manage firmware updates, serial number, Cropster, users, and support requests
- **Coffee Station:** (see <https://lamarzocco.com/app/coffee-station/>)
 - Digital representation of machine, grinder, and up to two scales.
 - Shared settings across all users.
- **Grind by Weight Functionality:**
 - **Scale Integration:** The new app enables grind-by-weight functionality by connecting La Marzocco connected scales to Pico and Swan grinders.
 - **Pico Compatibility:** Pico grinders have supported scale connectivity since initial production.
 - **Swan Compatibility:**
 - Swan grinders with S/N **SW000849** and later are compatible.
 - Swan grinders prior to S/N **SW000849** may require retrofit kit **1069** (gateway and cable) for connectivity. Contact Aftersales.

- Google and Apple login now supported

Important Notice for Linea Classic S Users:

If a firmware update is interrupted, the machine may display “uSu” on Group 1. Pressing k1-1 (the single-shot button) at this point can cause the bootloader to freeze, preventing the update from completing. If this occurs, please see document “Linea Classic S update interruptions” lamaroccousa.com/support in the section “tech bulletins”.

Portafilter Holder Kits

Secure portafilter holding kits for scale use are available:

- Pico: Kit 1068
- Swan: Kit 1067

Pico can be used with the scale and a dosing cup, without the holder, but the Swan requires the portafilter holder kit for proper operation.

Kit 1068

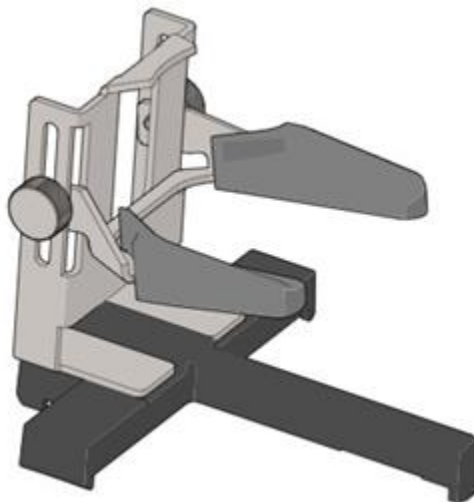

Do not hesitate to contact our solutions team with any questions you may have about this technical bulletin.

solutions.usa@lamarzocco.com

206.706.9104 x 1